

ROCKER HANDLE (WITH GUARDS) PRODUCTS

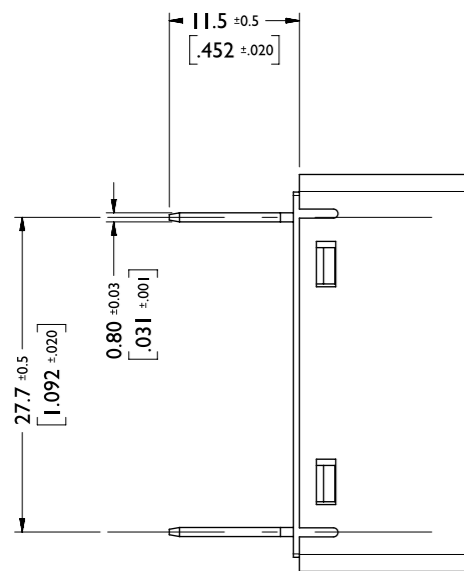

QUICK CONNECT TERMINAL

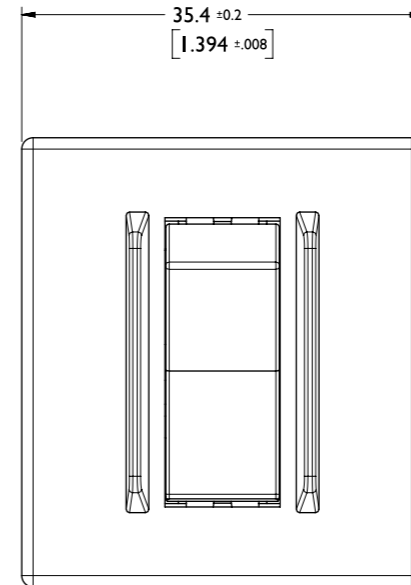
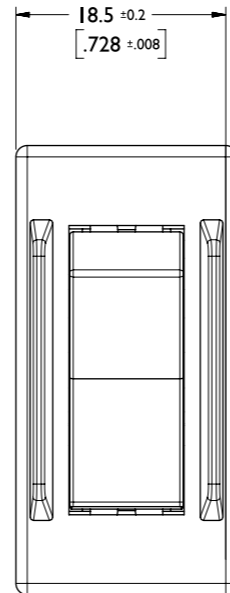
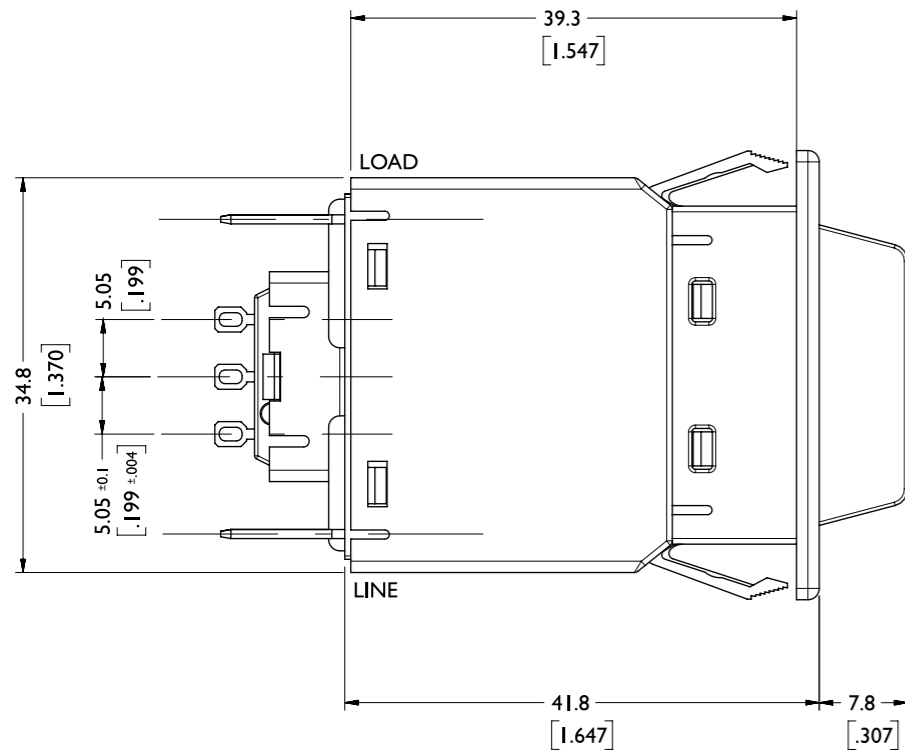
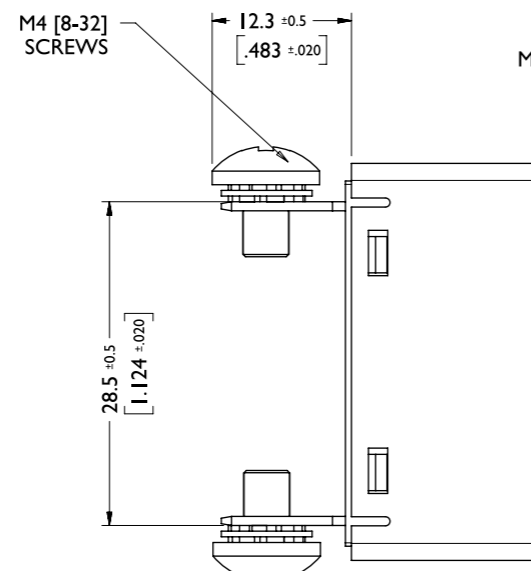
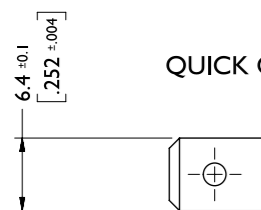

SCREW TERMINAL

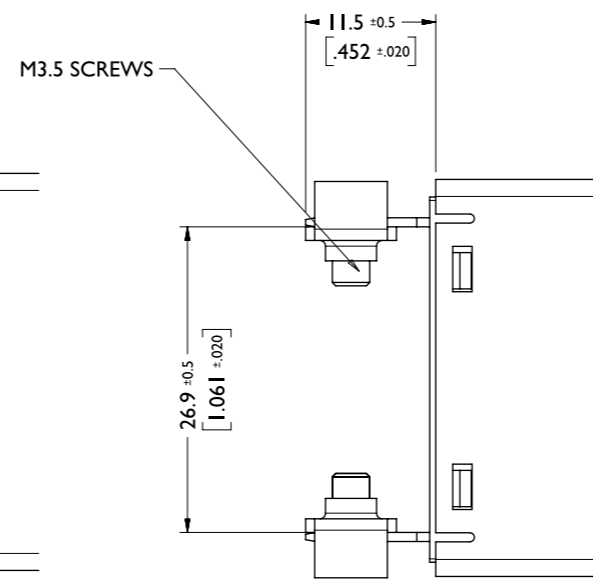

CLAMP TERMINAL

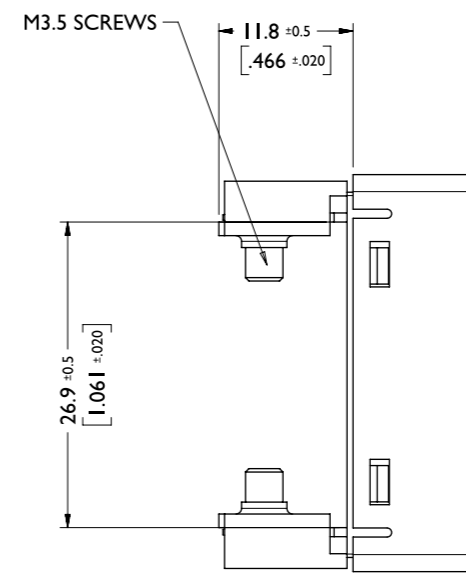

CLAMP TERMINAL (LONG)

MICRO SWITCH ONLY AVAILABLE WITH QUICK CONNECT TERMINALS

TOLERANCE ±0.4 UNLESS OTHERWISE SPECIFIED
(DIMENSION IN BRACKETS ARE IN INCH)

UNCONTROLLED

A	REFER TO PAGE 1 OF 10	CF
REV	DESCRIPTION	SIGN
	MATING FACE	-MF
	PROCESS DIMENSION	-PD
	INTERSECTION	-INT
	BEFORE PLATING	-BP
	ALL DIMENSIONS IN	-mm
	TOLERANCES ON UN-DIMENSIONED 90° FEATURES ARE ±0.5°	
	TOLERANCES < ±0.1 ARE CRITICAL	
	BRACKETED DIMENSIONS=EXISTING TOOLING	
	SURFACE AREA	N/A mm ²
	VOLUME	N/A mm ³
	MATERIAL	N/A
	RAW MTL No.	N/A
	FINISH	N/A
DRAWN	CF	DATE 29/09/2015
CHECK	APPD	
TOLERANCES	DO NOT SCALE	
X ±0.5	ORIGINAL SIZE A3	
X.X ±0.1		
X.XX ±0.05		
ANGULAR ±0.5°		

TITLE
B-FRAME
OUTLINE DRAWING



